



An **ALLSOP** Family Brand
 PO Box 23, Bellingham, WA 98227
 PH 800-426-4303
 www.allsop.com

ALLSOP Europe Limited,
 Industrial Park, Waterford, Ireland
 PH 353-51-355091
 www.allsop.eu

For more information visit
www.clingo.com

universal car dash mount™

hands-free mobile device use

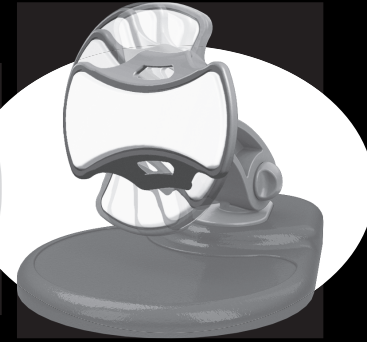

**USER
 GUIDE**
 PLEASE READ
 PRIOR TO USE

⚠ WARNING

Do not install Clingo products over an air bag cover or within the air bag deployment zone

⚠ UV/Sun: Periodically moving the Car Dash Mount location on the dash will help avoid any uneven sun fading that naturally occurs to the dashboard.

SETUP

UNIVERSAL CAR DASH MOUNT INSTALLATION

- Step 1:** Find a safe* location on the interior of the vehicle's dashboard to place the Car Dash Mount. Remove any excess dust from dashboard prior to Car Dash Mount placement. Place the Car Dash Mount on the dashboard and bend the base to fit the contour of your dashboard (**diagram 1**).
- Step 2:** Adjust the angle of the beam arm by loosening & tightening the adjustment knob (**A**) at the lower side to the desired height angle (**diagram 2**).
- Step 3:** Holding the beam arm securely, gently push the cradle onto the ball joint (**diagram 2**).

MOBILE DEVICE INSTALLATION

- Step 1:** Remove the protective film from Clingo pad.
- Step 2:** *This step is only for brand new cradles.* Press your device firmly onto the new Clingo pad. Immediately remove the device. If when removing device you find it too difficult, simply touch the Clingo gel pad to your shirt or pants until desired stickiness is reached.
- Step 3:** Check Clingo pad for cleanliness and stickiness before each use. Product will not stick properly if the pad is not cleaned suitably. See PROPER CARE & CLEANING for instructions. Cleaning frequency may vary by environment.
- Step 4:** Wipe dirt and dust from your mobile device. Now attach it firmly to the Clingo pad. **DO NOT** attach your mobile device to the Clingo pad if it is protected by a leather or silicone case. The Clingo pad **WILL NOT** stick to leather or silicone.
- Step 5:** Adjust the angle of the cradle to find the optimal hands-free viewing position.

REMOVING MOBILE DEVICE

- Method 1:** (*Two-handed*) The safest method, hold the Clingo cradle's "wings" with one hand and with the other hand wrap your fingers around to the back of the device to hold your battery cover. Gently peel the mobile device off the Clingo pad from one side to the other (**diagram 3**).
- Method 2:** (*One-handed*) Wrap your hand around the phone and while holding the back of your device (battery cover) with your finger tips, use your middle finger or thumb to gently peel the mobile device from the Clingo pad from one side to the other.

PROPER CARE & CLEANING

Proper care and use of the product is necessary to maintain optimal stickiness on Clingo pad.

FOR BEST CLINGO PAD CLEANING RESULTS

- Step 1:** Always remove the cradle from the beam arm and your mobile device from the Clingo pad before cleaning.
- Step 2:** Run warm water with mild soap over Clingo pad and use fingers to remove dirt and dust. **DO NOT** use solvents to clean the Clingo pad.
- Step 3:** Let the Clingo pad air dry completely before using. The Clingo pad **WILL NOT** stick when wet.

FOR QUICK CLEANING

For quick cleaning, use a damp, lint-free wipe or cloth (i.e. chamois) to remove dust, dirt and oil from Clingo pad or simply rinse with water and let it air dry (**diagram 4**). **DO NOT** use any paper products to wash or dry your Clingo product.

FOR BEST CAR DASH MOUNT BASE CLEANING RESULTS

Simply rinse the base with water and mild soap and let it air dry. **DO NOT** use any paper products to wash or dry your Clingo product.

CLINGO PAD

The Clingo pad is permanently bonded to the cradle. Do not attempt to remove the Clingo pad.

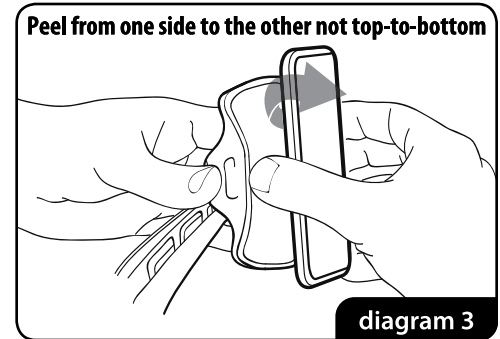
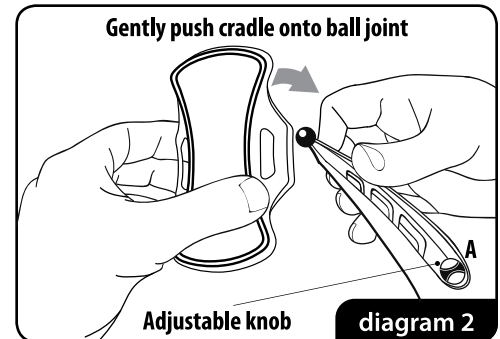
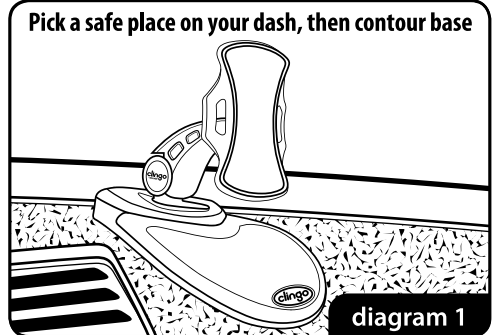

* SAFETY PRECAUTIONS

Do not install Clingo products over an air bag cover or within the air bag deployment zone. Allsop, Inc. and its subsidiaries assumes no responsibility of liability for injury or death as a result of car crashes and/or air bag deployment. Allsop, Inc. and its subsidiaries are not responsible for any damages caused to your car, your device, or yourself due to installation or use of this product.